

TOTAL EXTENT (AS PER DOC.) = 3078 Sq.M
 ROAD AREA = 521 Sq.M
 TOTAL No. OF PLOTS = 19 Nos

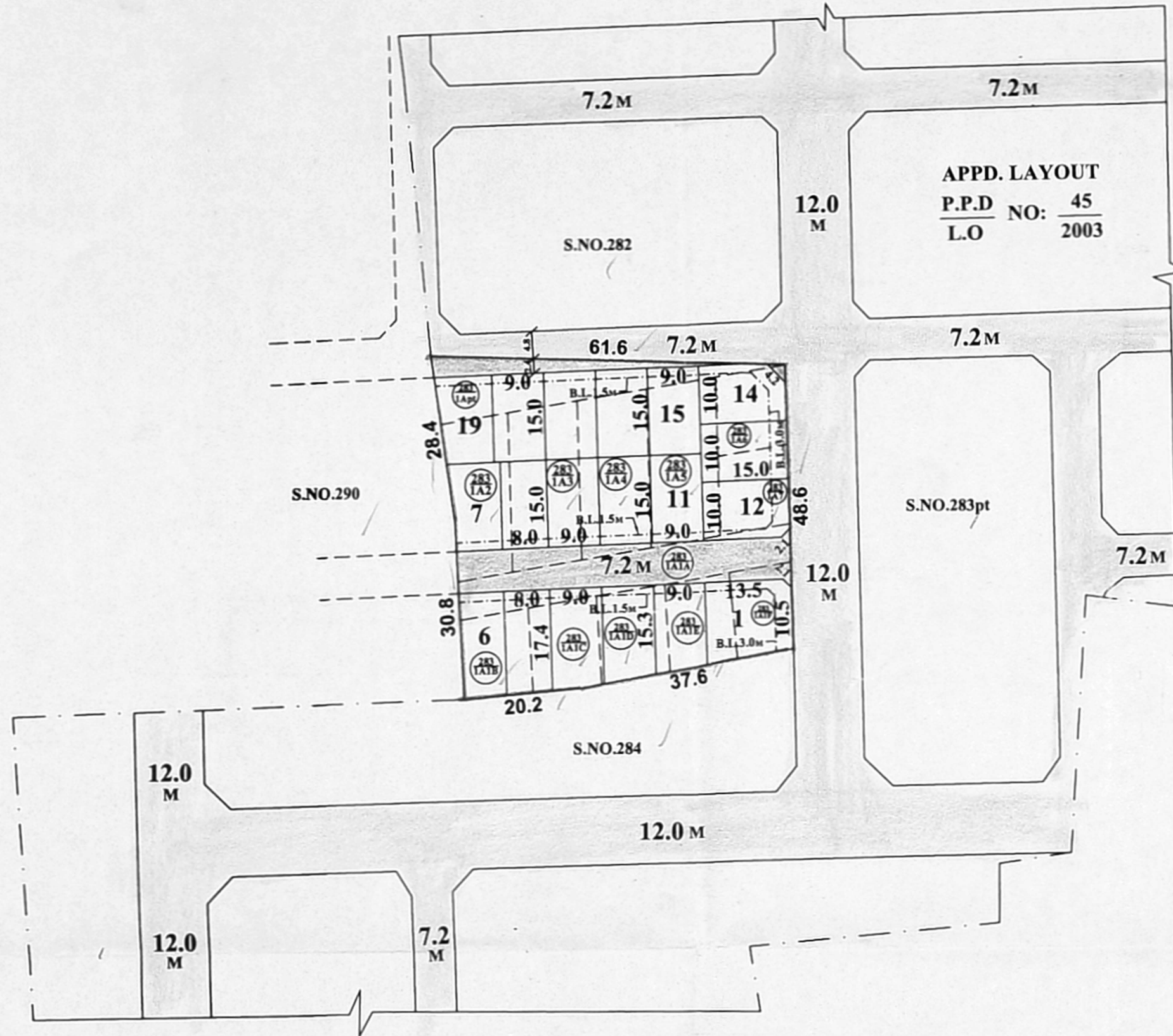

NOTE:

1. SPLAY - 3.0M x 3.0M, 1.5M x 1.5M
2. MEASUREMENTS ARE INDICATED EXCLUDING SPLAY DIMENSIONS
3. ROAD AREA WAS ALREADY HANDED OVER TO THE LOCAL BODY VIDE GIFT DEED DOC. NO.5855 / 2017, DATED: 02.11.2017, SRO @ PADAPPAL.

CONDITION

DR. RULE No: 29 (11):

THE COST OF LAYING IMPROVEMENTS TO THE SYSTEMS INRESPECT OF ROAD, WATER SUPPLY, SEWERAGE, DRAINAGE OR ELECTRIC POWER SUPPLY THAT MAY BE REQUIRED AS ASSESSED BY THE COMPETENT AUTHORITY, SHALL BE BORNE BY THE APPLICANT.

LEGEND

- SITE BOUNDARY
- ROADS ALREADY GIFTED
- EXISTING ROAD

CONDITIONS:

THE LAYOUT APPROVED IS VALID SUBJECT TO OBTAINING SANCTION FROM THE LOCAL BODY CONCERNED.

P.P.D NO: 60
 L.O NO: 2017

APPROVED

VIDE LETTER NO : L1/1969/2016
 DATE : 22/12/2017

S. D. S. 15/12/17
 PREPARED BY P.A.IV (S.M)

S. Rajalal 18/12/17
 CHECKED BY P.A.I (S.R)

[Signature] 18/12/2017
 A.P.(S.A)

[Signature] 22/12/2017
 FOR MEMBER SECRETARY
 CHENNAI METROPOLITAN
 DEVELOPMENT AUTHORITY 415

KUNRATHUR PANCHAYAT UNION

LAYOUT OF HOUSE SITES IN S.No: 283/1A1A, 1A1B, 1A1C, 1A1D, 1A1E, 1A1F, 1A2, 1A3, 1A4, 1A5, 1A6 & 1A7 OF PALANTHANDALAM VILLAGE.

SCALE : 1:800 (ALL MEASUREMENTS ARE IN METRE.)

